

NOTES

- ALL DIMENSIONS ARE IN MM.
- PROPOSED BUILDING PLAN FOR COMMERCIAL DEVELOPMENT UNDER LICENCE NO. 51 OF 2012 DATED: 17.05.2012 IN SECTOR 37-C OF THE MASTER PLAN FOR THE DEVELOPMENT OF THE NEARBY URBAN COMPLEX BEING DEVELOPED BY M/S IMPERIA WISFIELD PVT LTD.
- THIS IS A PROPOSED BUILDING PLAN FOR APPROVAL FOR THE PURPOSE OF BUILDING APPROVAL ONLY. IT IS NOT TO BE USED FOR ANY OTHER PURPOSE.
- ALL BUILDINGS ARE TO BE CONSTRUCTED AS PER THE SPECIFICATIONS AND STANDARDS MENTIONED IN THE DRAWINGS.
- ALL BUILDINGS ARE TO BE CONSTRUCTED AS PER THE SPECIFICATIONS AND STANDARDS MENTIONED IN THE DRAWINGS.
- ALL BUILDINGS ARE TO BE CONSTRUCTED AS PER THE SPECIFICATIONS AND STANDARDS MENTIONED IN THE DRAWINGS.
- ALL BUILDINGS ARE TO BE CONSTRUCTED AS PER THE SPECIFICATIONS AND STANDARDS MENTIONED IN THE DRAWINGS.
- ALL BUILDINGS ARE TO BE CONSTRUCTED AS PER THE SPECIFICATIONS AND STANDARDS MENTIONED IN THE DRAWINGS.
- ALL BUILDINGS ARE TO BE CONSTRUCTED AS PER THE SPECIFICATIONS AND STANDARDS MENTIONED IN THE DRAWINGS.
- ALL BUILDINGS ARE TO BE CONSTRUCTED AS PER THE SPECIFICATIONS AND STANDARDS MENTIONED IN THE DRAWINGS.

OWNER SIGNATURE
ARCHITECT SIGNATURE
ARCHITECT SIGNATURE

PROJECT TITLE
PROPOSED BUILDING PLAN FOR COMMERCIAL DEVELOPMENT UNDER LICENCE NO. 51 OF 2012 DATED: 17.05.2012 IN SECTOR 37-C OF THE MASTER PLAN FOR THE DEVELOPMENT OF THE NEARBY URBAN COMPLEX BEING DEVELOPED BY M/S IMPERIA WISFIELD PVT LTD.

DATE 07-04-2023
DWG. NO. SUM-5
SCALE 1:125
DRAWN BY NORTH
DATE 17-10-2023

ACPL Design Ltd
 Architects & Planners
 100, 1001, 2008
 100, 1001, 2008

| NON-FAR AREAS | 1 | 2 | 3 | 4 | 5 | 6 | 7 | 8 | 9 | 10 | 11 | 12 | 13 | 14 | 15 | 16 | 17 | 18 | 19 | 20 | 21 | 22 | 23 | 24 | 25 | 26 | 27 | 28 | 29 | 30 | 31 | 32 | 33 | 34 | | | |
|---------------|--------|--------|--------|--------|--------|--------|--------|--------|--------|--------|--------|--------|--------|--------|--------|--------|--------|--------|--------|--------|--------|--------|--------|--------|--------|--------|--------|--------|--------|--------|--------|--------|--------|--------|--------|--------|--------|
| ADDITIONS | 65.720 | 47.830 | 47.830 | 47.830 | 47.830 | 47.830 | 47.830 | 47.830 | 47.830 | 47.830 | 47.830 | 47.830 | 47.830 | 47.830 | 47.830 | 47.830 | 47.830 | 47.830 | 47.830 | 47.830 | 47.830 | 47.830 | 47.830 | 47.830 | 47.830 | 47.830 | 47.830 | 47.830 | 47.830 | 47.830 | 47.830 | 47.830 | 47.830 | 47.830 | 47.830 | | |
| SUBTRACTION | 18.300 | 10.160 | 10.160 | 10.160 | 10.160 | 10.160 | 10.160 | 10.160 | 10.160 | 10.160 | 10.160 | 10.160 | 10.160 | 10.160 | 10.160 | 10.160 | 10.160 | 10.160 | 10.160 | 10.160 | 10.160 | 10.160 | 10.160 | 10.160 | 10.160 | 10.160 | 10.160 | 10.160 | 10.160 | 10.160 | 10.160 | 10.160 | 10.160 | 10.160 | 10.160 | 10.160 | |
| TOTAL | 47.420 | 37.670 | 37.670 | 37.670 | 37.670 | 37.670 | 37.670 | 37.670 | 37.670 | 37.670 | 37.670 | 37.670 | 37.670 | 37.670 | 37.670 | 37.670 | 37.670 | 37.670 | 37.670 | 37.670 | 37.670 | 37.670 | 37.670 | 37.670 | 37.670 | 37.670 | 37.670 | 37.670 | 37.670 | 37.670 | 37.670 | 37.670 | 37.670 | 37.670 | 37.670 | 37.670 | 37.670 |

| ADDITIONS | II | III | IV | V | VI | VII | VIII | IX | X | XI | XII | XIII | XIV | XV | XVI | XVII | XVIII | XIX | XX | XXI | XXII | XXIII | XXIV | XXV | XXVI | XXVII | XXVIII | XXIX | XXX | XXXI | XXXII | XXXIII | XXXIV | XXXV | XXXVI | XXXVII | XXXVIII | XXXIX | XL | |
|-------------|--------|--------|--------|--------|--------|--------|--------|--------|--------|--------|--------|--------|--------|--------|--------|--------|--------|--------|--------|--------|--------|--------|--------|--------|--------|--------|--------|--------|--------|--------|--------|--------|--------|--------|--------|--------|---------|--------|--------|--------|
| ADDITIONS | 65.720 | 47.830 | 47.830 | 47.830 | 47.830 | 47.830 | 47.830 | 47.830 | 47.830 | 47.830 | 47.830 | 47.830 | 47.830 | 47.830 | 47.830 | 47.830 | 47.830 | 47.830 | 47.830 | 47.830 | 47.830 | 47.830 | 47.830 | 47.830 | 47.830 | 47.830 | 47.830 | 47.830 | 47.830 | 47.830 | 47.830 | 47.830 | 47.830 | 47.830 | 47.830 | 47.830 | 47.830 | 47.830 | 47.830 | 47.830 |
| SUBTRACTION | 18.300 | 10.160 | 10.160 | 10.160 | 10.160 | 10.160 | 10.160 | 10.160 | 10.160 | 10.160 | 10.160 | 10.160 | 10.160 | 10.160 | 10.160 | 10.160 | 10.160 | 10.160 | 10.160 | 10.160 | 10.160 | 10.160 | 10.160 | 10.160 | 10.160 | 10.160 | 10.160 | 10.160 | 10.160 | 10.160 | 10.160 | 10.160 | 10.160 | 10.160 | 10.160 | 10.160 | 10.160 | 10.160 | 10.160 | 10.160 |
| TOTAL | 47.420 | 37.670 | 37.670 | 37.670 | 37.670 | 37.670 | 37.670 | 37.670 | 37.670 | 37.670 | 37.670 | 37.670 | 37.670 | 37.670 | 37.670 | 37.670 | 37.670 | 37.670 | 37.670 | 37.670 | 37.670 | 37.670 | 37.670 | 37.670 | 37.670 | 37.670 | 37.670 | 37.670 | 37.670 | 37.670 | 37.670 | 37.670 | 37.670 | 37.670 | 37.670 | 37.670 | 37.670 | 37.670 | 37.670 | 37.670 |

| NON-FAR AREAS | 1 | 2 | 3 | 4 | 5 | 6 | 7 | 8 | 9 | 10 | 11 | 12 | 13 | 14 | 15 | 16 | 17 | 18 | 19 | 20 | 21 | 22 | 23 | 24 | 25 | 26 | 27 | 28 | 29 | 30 | 31 | 32 | 33 | 34 | | | | | | |
|---------------|--------|--------|--------|--------|--------|--------|--------|--------|--------|--------|--------|--------|--------|--------|--------|--------|--------|--------|--------|--------|--------|--------|--------|--------|--------|--------|--------|--------|--------|--------|--------|--------|--------|--------|--------|--------|--------|--------|--------|--------|
| ADDITIONS | 65.720 | 47.830 | 47.830 | 47.830 | 47.830 | 47.830 | 47.830 | 47.830 | 47.830 | 47.830 | 47.830 | 47.830 | 47.830 | 47.830 | 47.830 | 47.830 | 47.830 | 47.830 | 47.830 | 47.830 | 47.830 | 47.830 | 47.830 | 47.830 | 47.830 | 47.830 | 47.830 | 47.830 | 47.830 | 47.830 | 47.830 | 47.830 | 47.830 | 47.830 | 47.830 | 47.830 | 47.830 | 47.830 | 47.830 | |
| SUBTRACTION | 18.300 | 10.160 | 10.160 | 10.160 | 10.160 | 10.160 | 10.160 | 10.160 | 10.160 | 10.160 | 10.160 | 10.160 | 10.160 | 10.160 | 10.160 | 10.160 | 10.160 | 10.160 | 10.160 | 10.160 | 10.160 | 10.160 | 10.160 | 10.160 | 10.160 | 10.160 | 10.160 | 10.160 | 10.160 | 10.160 | 10.160 | 10.160 | 10.160 | 10.160 | 10.160 | 10.160 | 10.160 | 10.160 | 10.160 | |
| TOTAL | 47.420 | 37.670 | 37.670 | 37.670 | 37.670 | 37.670 | 37.670 | 37.670 | 37.670 | 37.670 | 37.670 | 37.670 | 37.670 | 37.670 | 37.670 | 37.670 | 37.670 | 37.670 | 37.670 | 37.670 | 37.670 | 37.670 | 37.670 | 37.670 | 37.670 | 37.670 | 37.670 | 37.670 | 37.670 | 37.670 | 37.670 | 37.670 | 37.670 | 37.670 | 37.670 | 37.670 | 37.670 | 37.670 | 37.670 | 37.670 |

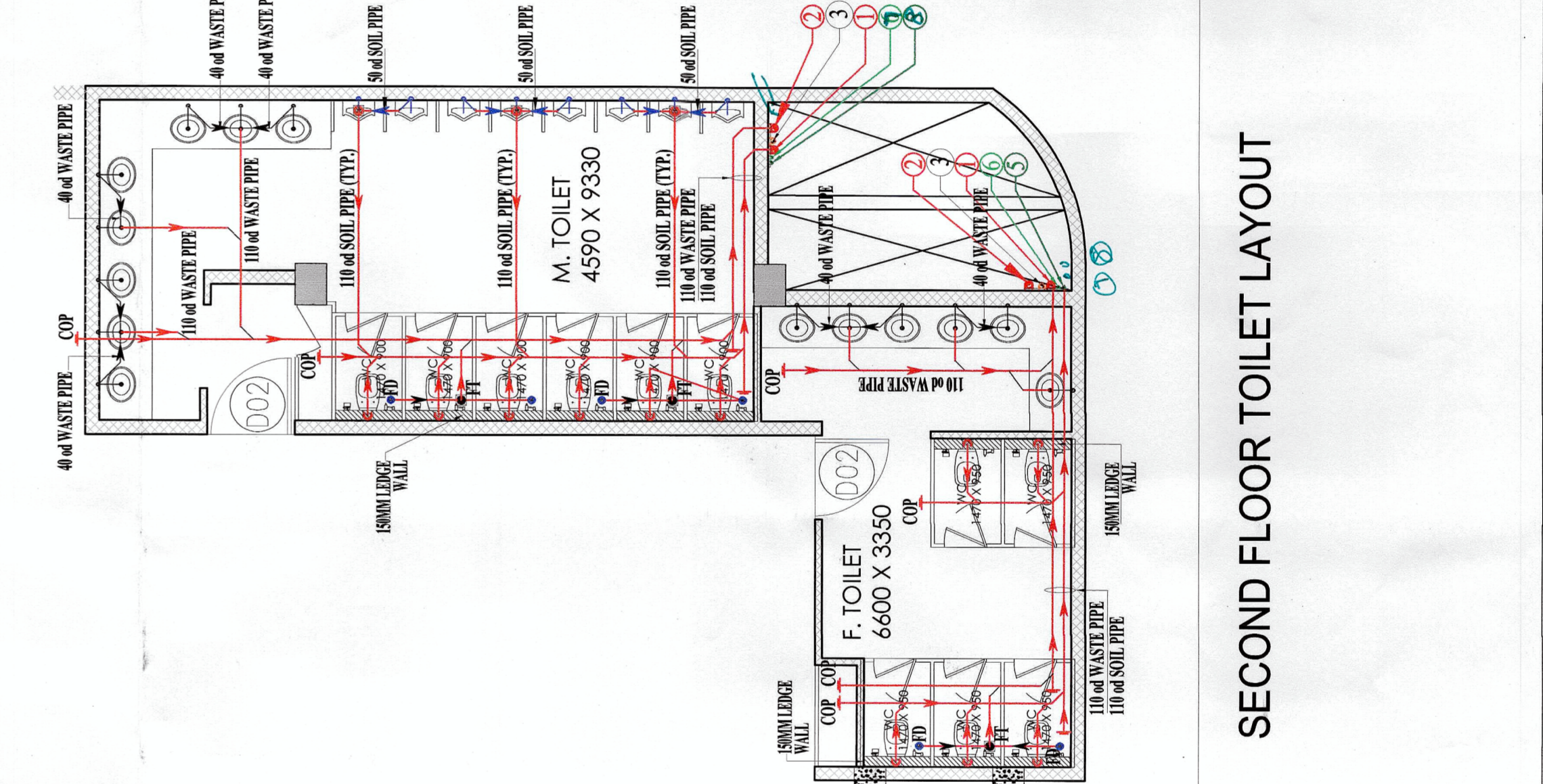

| AREA | TOTAL OCCU. | TOTAL | PERMANENT POPULATION | F | M | F | M | TOTAL |
|--------------------|-------------|-------|----------------------|----|----|-----|-----|-------|
| 2ND FLOOR (RETAIL) | 1733 | 289 | 29 | 17 | 12 | 156 | 104 | 260 |
| WC | | | 2 | 1 | 4 | 3 | 6 | 4 |
| BASIN | | | 1 | 1 | 1 | 1 | 4 | 4 |
| URINALS | | | 1 | 1 | 4 | 1 | 4 | 4 |

| S.NO. | TYPE | SIZE | CILL LVL. | LINTEL LVL. | REMARKS |
|-------|------|-----------|-----------|-------------|----------------------|
| 01. | FD | 2000x2400 | 00 | 2400 | STAIRCASE FIRE LOBBY |
| 02. | FD1 | 1250x2400 | 00 | 2400 | STAIRCASE |
| 03. | FD2 | 1500x2400 | 00 | 2400 | STAIRCASE SERVICES |
| 04. | G1 | 1500x2400 | 00 | 2400 | SHOP |
| 05. | D02 | 1250x2400 | 00 | 2400 | TOILET SERVICES |

PUMPING LEGEND

- 100 MM Ø SH-4 DEPT. LITE
- 100 MM Ø WASTE & VENT PIPE
- 75 MM Ø RAIN WATER PIPE
- 75 MM Ø RAIN WATER PIPE
- DOMESTIC WATER SUPPLY RISER
- DOMESTIC WATER SUPPLY RISER
- DOMESTIC WATER SUPPLY RISER
- PLUMBING WATER SUPPLY ON-TAKE

SECOND FLOOR TOILET LAYOUT